



| FASCO MODEL   | TYPE | VOLTS       | SPD. | AMPS    | CROSS REF.   | FIG. | NOTES |
|---------------|------|-------------|------|---------|--|------|-------|
| ▶ <b>A087</b> | PSC  | 115/230     | 1    | 2.8/1.1 | Air Plus 7062-4087, Scherba Industries 7062-3496                 | A    |       |
| ▶ <b>A120</b> | SP   | 120         | 2    | 1.1     | Aladdin Steel 7002-2983, Hearth and Home Models 7002-2983        | B    |       |
| <b>A129</b>   | SP   | 115         | 1    | 1.95    | Amana 7021-9064, 7021-9259                                       | C    |       |
| <b>A158</b>   | PSC  | 115         | 1    | 4.5     | Amana 7062-3151, 7062-3703                                       | D    | 133   |
| <b>A160</b>   | SP   | 115         | 1    | 1.6     | Amana 7002-2407  | E    |       |
| <b>A085</b>   | SP   | 230         | 1    | 0.7     | AO Smith 464 Johnson Furnace                                     | F    |       |
| <b>A155</b>   | SP   | 115         | 1    | 1.4     | Armstrong 7021-10046   | G    |       |
| <b>A161</b>   | SP   | 230         | 1    | 0.6     | Brinkley 8353920103, Fedders 8353920103                          | H    | 51    |
| <b>A088</b>   | SP   | 115         | 1    | 1.3     | Coleman 7021-6759; Dornback 7021-5478; York 7021-8629, 7021-7105 | I    |       |
| <b>A128</b>   | SP   | 120         | 1    | 0.9     | Consolidated Industries 7021-6376, 7021-9404                     | J    |       |
| <b>A156</b>   | SP   | 115         | 1    | 1.1     | Evcon 7021-8935  | K    |       |
| ▶ <b>A100</b> | SP   | 115         | 1    | 1.21    | Excel 7058-0280  | L    |       |
| <b>A159</b>   | SP   | 230         | 1    | 0.5     | Fedders 11-7096, AK4K84BX  | M    | 51    |
| <b>B23617</b> | SP   | 115/230     | 1    | .9/.4   | Franklin 80270   | N    | 51    |
| <b>B23618</b> | SP   | 115/208-230 | 1    | .95-.45 | Franklin 80270   | O    | 51    |
| ▶ <b>A110</b> | SP   | 115         | 1    | .76     | Frymaster 7002-3512  | P    |       |
| ▶ <b>A111</b> | SP   | 208-240     | 1    | 0.8     | Frymaster 7021-11714   | Q    |       |
| <b>A140</b>   | SP   | 115         | 1    | 1.4     | Goodman 7021-9087, 7021-9000                                     | R    |       |

NOTES: 51: Includes centrifugal switch 133: 4M 250V Capacitor included



FIG. A **A087**



FIG. B **A120**



FIG. C **A129**



FIG. D **A158**



FIG. E **A160**



FIG. F **A085**



FIG. G **A155**



FIG. H **A161**



FIG. I **A088**



FIG. J **A128**



FIG. K **A156**



FIG. L **A100**



FIG. M **A159**



FIG. N **B23617**



FIG. O **B23618**



FIG. P **A110**



FIG. Q **A111**



FIG. R **A140**

Thermally protected • UL recognized • CSA or ULc certified  
**NOTE:** Rotation is determined by looking at shaft end. Shaft length is measured from motor face.

▶ NEW ITEM! See page 113 for a complete listing of all our new products.



| FASCO MODEL | TYPE | VOLTS   | SPD. | AMPS      | CROSS REF.            | FIG. | NOTES |
|-------------|------|---------|------|-----------|-----------------------|------|-------|
| A157        | SP   | 115     | 1    | 1.3       | Goodman 7002-2307     | A    |       |
| A162        | SP   | 208-230 | 1    | 0.5       | Goodman 7021-8656     | B    | 51    |
| A180        | SP   | 115     | 1    | 1.8       | Goodman 7021-9625     | C    |       |
| A181        | SP   | 115     | 1    | 1.5       | Goodman 7058-0136     | D    |       |
| A182        | SP   | 115     | 1    | 1.2       | Goodman 7002-3036     | E    |       |
| A184        | SP   | 115     | 1    | 1.55      | Goodman 7058-0229     | F    |       |
| A185        | SP   | 115     | 1    | 1.15      | Goodman 7021-9316     | G    |       |
| A187        | SP   | 208-230 | 1    | 0.8       | Goodman 7021-10006    | H    |       |
| A188        | SP   | 115     | 1    | 1.6       | Goodman 7021-10958    | I    |       |
| A189        | SP   | 115     | 1    | 1.5       | Goodman 7021-7302     | J    |       |
| A280        | SP   | 115     | 1    | 1.5       | Goodman 7021-7794     | J    |       |
| A281        | SP   | 115     | 1    | 0.9       | Goodman 7021-8252     | K    |       |
| A282        | SP   | 220     | 1    | 0.45      | Goodman 7021-8448     | L    |       |
| A283        | SP   | 115     | 1    | 1.5       | Goodman 7021-8730     | J    |       |
| A284        | SP   | 208/240 | 1    | 0.59/0.50 | Goodman 7021-9227     | K    |       |
| A285        | SP   | 115     | 2    | 1.4       | Goodman 7021-9236     | M    |       |
| A286        | SP   | 208/230 | 1    | 0.6       | Goodman 7021-9398     | G    |       |
| A287        | SP   | 115     | 1    | 1.15      | Goodman 7021-9655     | G    |       |
| A288        | SP   | 115     | 2    | 1.4/0.65  | Goodman 7021-9727     | G    |       |
| A289        | SP   | 208/230 | 1    | 0.75      | Goodman 7058-0081     | D    |       |
| A290        | SP   | 115     | 2    | 0.7       | Goodman 7062-5015     | N    |       |
| A133        | SP   | 115     | 1    | 1.2       | Heat-n-Glow 7002-1241 | O    |       |

NOTES: 51: Includes centrifugal switch



FIG. A A157



FIG. B A162



FIG. C A180



FIG. D A181, A289



FIG. E A182



FIG. F A184



FIG. G A185, A286, A287, A288



FIG. H A187



FIG. I A188



FIG. J A189, A280, A283



FIG. K A281, A284



FIG. L A282



FIG. M A285



FIG. N A290



FIG. O A133



| FASCO MODEL | TYPE | VOLTS   | SPD. | AMPS | CROSS REF.   | FIG. | NOTES |
|-------------|------|---------|------|------|--|------|-------|
| A064        | SP   | 115     | 1    | 0.7  | Heil Quaker 610172, 7021-5043, 7021-7102                                 | A    |       |
| A134        | SP   | 115     | 1    | 1.5  | InterCity Products 7021-9335, 7021-8735, 7021-9499, 7021-8736, 7021-7700 | B    |       |
| A145        | PSC  | 115     | 1    | 0.7  | InterCity Products 7062-4061   | C    | 133   |
| A141        | SP   | 115     | 1    | 1    | InterCity Products 7021-8741, 7021-8742, 7021-9188                       | D    |       |
| A148        | SP   | 208-230 | 1    | 0.5  | InterCity Products 7021-7617, 7021-9237                                  | E    |       |
| A151        | SP   | 230     | 1    | 0.3  | InterCity Products HQ1050144   | F    |       |
| A169        | SP   | 230     | 1    | 0.75 | InterCity Products 7021-10048, 7021-10580                                | G    |       |
| A170        | SP   | 115     | 1    | 2.3  | InterCity Products 7021-10299, 7021-10702                                | H    |       |
| A171        | PSC  | 115     | 1    | 0.7  | InterCity Products 7062-4783, 7062-4705, 7062-4274, 7062-4201, 7062-4549 | I    |       |
| A172        | SP   | 115     | 1    | 1.6  | InterCity Products 7002-2792, 7002-2633                                  | J    |       |
| A173        | PSC  | 115     | 1    | 0.8  | InterCity Products 7062-4785, Alltemp (ROTOM) 7062-4832                  | K    |       |
| A174        | SP   | 115     | 1    | 0.8  | InterCity Products 7021-9188   | D    |       |
| A175        | SP   | 115     | 1    | 1    | InterCity Products 7002-1891   | L    |       |
| A176        | SP   | 115     | 1    | 2.2  | InterCity Products 7002-2946   | M    |       |
| A177        | SP   | 115     | 2    | 1.4  | InterCity Products 7021-10363  | B    |       |
| A178        | SP   | 115     | 1    | 1.8  | InterCity Products 7021-10928  | N    |       |
| A179        | SP   | 115     | 1    | 0.9  | InterCity Products 7021-8693   | O    |       |
| A301        | SP   | 115     | 1    | 0.8  | InterCity Products 7021-9498   | D    |       |
| A302        | SP   | 115     | 1    | 1.5  | InterCity Products 7021-9499   | B    |       |
| A304        | SP   | 115     | 1    | 1.5  | InterCity Products 7021-9701   | B    |       |

NOTES: 133: 4M 250V Capacitor included



FIG. A A064



FIG. B A134, A177, A302, A304



FIG. C A145



FIG. D A141, A174, A301



FIG. E A148



FIG. F A151



FIG. G A169



FIG. H A170



FIG. I A171



FIG. J A172



FIG. K A173



FIG. L A175



FIG. M A176



FIG. N A178



FIG. O A179

Thermally protected • UL recognized • CSA or ULc certified

NOTE: Rotation is determined by looking at shaft end. Shaft length is measured from motor face.

▶ NEW ITEM! See page 113 for a complete listing of all our new products.



| FASCO MODEL | TYPE | VOLTS   | SPD. | AMPS | CROSS REF.                                | FIG. | NOTES |
|-------------|------|---------|------|------|---|------|-------|
| ▶ A306      | PSC  | 208-230 | 2    | 0.3  | InterCity Products 7062-4532              | A    |       |
| A135        | SP   | 120     | 1    | 0.7  | Lennox 7021-8812, 7021-8819               | B    |       |
| A138        | SP   | 120     | 1    | 0.7  | Lennox 7021-8657, 7021-8825               | B    |       |
| A163        | SP   | 115     | 1    | 1.8  | Lennox 7021-9450                          | C    |       |
| A164        | SP   | 120     | 1    | 0.8  | Lennox 7021-9593                          | D    |       |
| ▶ A200      | SP   | 115     | 1    | 1.95 | Lennox 7002-2975                          | E    |       |
| ▶ A201      | SP   | 208-230 | 1    | 0.65 | Lennox 7021-10055, 7021-10743             | F    |       |
| ▶ A202      | SP   | 115     | 1    | 1.8  | Lennox 7021-10602, 7021-11106, 7021-11174 | G    |       |
| ▶ A203      | SP   | 115     | 1    | 1.8  | Lennox 7021-10841                         | H    |       |
| ▶ A204      | SP   | 115     | 1    | 1.8  | Lennox 7021-11406                         | I    |       |
| ▶ A205      | SP   | 120     | 1    | 0.7  | Lennox 7021-8372, 7021-9001               | J    |       |
| ▶ A206      | SP   | 115     | 1    | 1.5  | Lennox 7021-8473, 7021-8983               | K    |       |
| ▶ A207      | SP   | 115     | 1    | 1.75 | Lennox 7058-0217                          | L    |       |
| ▶ A208      | SP   | 115     | 1    | 1.75 | Lennox 7058-0322                          | M    |       |
| ▶ A209      | PSC  | 115     | 2    | 0.8  | Lennox 7062-5441                          | N    |       |
| ▶ A210      | SP   | 115     | 2    | 1.7  | Lennox 7021-11063                         | O    |       |
| ▶ A211      | SP   | 115     | 1    | 2.35 | Lennox 7021-11634                         | P    |       |
| ▶ A217      | SP   | 230     | 1    | 0.8  | Lennox 7021-11231                         | Q    |       |



FIG. A A306



FIG. B A135, A138



FIG. C A163



FIG. D A164



FIG. E A200



FIG. F A201



FIG. G A202



FIG. H A203



FIG. I A204



FIG. J A205



FIG. K A206



FIG. L A207



FIG. M A208



FIG. N A209



FIG. O A210



FIG. P A211



FIG. Q A217



| FASCO MODEL | TYPE | VOLTS   | SPD. | AMPS    | CROSS REF.  | FIG. | NOTES  |
|-------------|------|---------|------|---------|---|------|--------|
| A218        | SP   | 220-240 | 1    | .60/.52 | Lennox 7021-10676   | A    |        |
| A219        | SP   | 120     | 1    | 0.7     | Lennox 7021-9262  | B    |        |
| A322        | SP   |         | 2    |         | Lennox 7021-9884  | C    |        |
| A324        | PSC  |         | 1    |         | Lennox 7062-1909  | D    |        |
| A331        | PSC  |         | 1    |         | Lennox 7062-5554  | E    |        |
| A081        | SP   | 230     | 1    | 0.5     | Magic Chef, HWC Series 48HWC24A, 48HWC181, 35HWC181, 60HW, 60HWC24A, 60HWC181, 48HW, 60HWC30A, 66HWC18A, 36HWC241, 66HW, 60HWC241, 66HWC181, 66HWC241, 60HWC301, 48HWC241, 66HWC301, 48HWC18A, 60HWC18A, 36HWC18A, 66HWC24A, 36HW, 36HWC24A | F    | 50,134 |
| A131        | SP   | 115     | 1    | 1.1     | Nordyne 7021-9132, 7021-10171, 7021-10159, 7021-9661  | G    |        |
| A132        | SP   | 115     | 1    | 1.1     | Nordyne 7021-7975   | H    |        |
| A121        | SP   | 240     | 1    | 0.51    | Nordyne 7021-10381  | I    |        |
| A122        | SP   | 115     | 1    | 1.75    | Nordyne 7021-11227  | J    |        |
| A123        | SP   | 115     | 1    | 1.95    | Nordyne 7021-11385  | K    |        |
| A124        | SP   | 115     | 1    | 1.75    | Nordyne 7021-11379  | L    |        |
| A126        | SP   | 115     | 1    | 1.8     | Nordyne 7002-3158   | M    |        |
| A079        | SP   | 115     | 1    | 1.1     | Rheem Ruud 74-70-21496-03-01, 74-70-21504-03-04; Goodman B1859000, 7021-6804, JA1M106, JA1M137; Trane B1W24, WG94X167   | N    |        |
| A090        | SP   | 115     | 1    | 1.1     | Rheem 70-21496-01, 7021-5239, JA1M102, 7021-5715  | O    |        |

NOTES: 50: Stainless steel shaft 134: Replacement for Airease, Armstrong and Magic Chef



FIG. A A218



FIG. B A219



FIG. C A322



FIG. D A324



FIG. E A331



FIG. F A081



FIG. G A131



FIG. H A132



FIG. I A121



FIG. J A122



FIG. K A123



FIG. L A124



FIG. M A126



FIG. N A079



FIG. O A090

Thermally protected • UL recognized • CSA or ULc certified  
**NOTE:** Rotation is determined by looking at shaft end. Shaft length is measured from motor face.

▶ NEW ITEM! See page 113 for a complete listing of all our new products.





| FASCO MODEL | TYPE | VOLTS   | SPD. | AMPS    | CROSS REF.   | FIG. | NOTES |
|-------------|------|---------|------|---------|--|------|-------|
| A136        | PSC  | 115     | 1    | 0.75    | Rheem 7062-3861  | A    |       |
| A139        | SP   | 115     | 1    | 0.95    | Rheem 7021-7577  | B    |       |
| A086        | SP   | 115     | 1    | 1.3     | Rheem JA1N065, 7021-5239, JA1N062; Universal Electric JA1N069; 20th Century 7021-5853, 7021-7104       | C    |       |
| A142        | PSC  | 115     | 1    | 0.7     | Rheem 7062-1881, 7062-2615; PMI/Vulcan Hart 7062-2513  | D    | 20    |
| A240        | SP   | 115     | 1    | 1.1     | Rheem 7021-8183  | E    |       |
| A241        | SP   | 208-230 | 1    | 0.62    | Rheem 7021-9567  | F    |       |
| A242        | SP   | 115     | 1    | 1.36    | Rheem 7021-7150  | G    |       |
| A243        | SP   | 115     | 1    | 1.36    | Rheem 7021-7790  | H    |       |
| A244        | SP   | 208-230 | 1    | 0.85    | Rheem 7021-6967  | I    |       |
| A245        | SP   | 208-230 | 1    | .95/.85 | Rheem 7021-7490  | J    |       |
| A246        | PSC  | 115     | 2    | 0.85    | Rheem 7062-3925S, 7062-5272  | K    |       |
| A247        | PSC  | 115     | 2    | 0.95    | Rheem 7062-5519S   | L    |       |
| A251        | SP   | 208-230 | 1    | 1.1     | Skymark 7021-9136  | M    |       |
| A073        | SP   | 115-230 | 1    | .7/.35  | Tappan, Janitrol, SJC, Arkla, Franklin 8251560133, 829932, 8351520243                                  | N    |       |
| A143        | SP   | 115     | 1    | 0.95    | Trane 7021-8428, 7021-8013, 7021-8924, 7021-9639, 7021-9055, 7002-2558, 7002-3273; Jakel J238-138-1344 | O    |       |
| A146        | SP   | 115     | 2    | 1-.35   | Trane 7021-7986, 7002-2531, 7021-8925  | P    |       |
| A069        | SP   | 208-240 | 1    | 0.5     | Trane 38040252, 82252, 7021-6682   | Q    |       |
| A075        | SP   | 230     | 1    | 0.4     | Trane 38050005, 7021-6681; Franklin 82005  | R    | 51    |

NOTES: 20: 4M 370V Capacitor included 51: Includes centrifugal switch



FIG. A A136



FIG. B A139



FIG. C A086



FIG. D A142



FIG. E A240



FIG. F A241



FIG. G A242



FIG. H A243



FIG. I A244



FIG. J A245



FIG. K A246



FIG. L A247



FIG. M A251



FIG. N A073



FIG. O A143



FIG. P A146



FIG. Q A069



FIG. R A075



| FASCO MODEL | TYPE | VOLTS   | SPD. | AMPS    | CROSS REF.  | FIG. | NOTES |
|-------------|------|---------|------|---------|---|------|-------|
| A130        | PSC  | 115     | 1    | 0.7     | Trane 7062-3956, 7021-4004, 7062-5247, 7062-3616, 7062-5575, D330757P04, D342094P04; Nordyne 7062-4159, 7062-4639 | A    | 20    |
| A150        | SP   | 208-230 | 1    | 0.5     | Trane 7021-7833, 7021-8928  | B    |       |
| A190        | BLDC | 115     | VAR  | -       | Trane 7000-5838, 7000-5833  | C    |       |
| A191        | SP   | 208-230 | 1    | 0.8     | Trane 7021-6683   | D    |       |
| A192        | SP   | 115     | 1    | 1       | Trane 7021-8569   | E    |       |
| A193        | SP   | 208-240 | 1    | .59/.5  | Trane 7021-8591   | F    |       |
| A194        | SP   | 115     | 2    | 1.0/.5  | Trane 7021-9561   | G    |       |
| A195        | SP   | 115     | 1    | 1.75    | Trane 7021-11543S, 7021-11543   | H    |       |
| A196        | SP   | 115     | 1    | 1.35    | Trane 7021-11544S, 7021-11544, 7021-9065  | I    |       |
| A197        | 3PH  | 33-110  | VAR  | 1       | Trane 7092-0238S, 7092-0238   | J    |       |
| A198        | SP   | 115     | 1    | 1.75    | Trane 7058-0259   | K    |       |
| A199        | SP   | 115     | 1    | 1.75    | Trane 7058-0260   | K    |       |
| A260        | SP   | 115     | 1    | 1       | Trane 7058-0261   | K    |       |
| A261        | SP   | 115     | 1    | 1       | Trane 7058-0262   | K    |       |
| A262        | SP   | 115     | 1    | 1       | Trane 7058-0263   | K    |       |
| A263        | SP   | 115     | 1    | 1       | Trane 7058-0264   | K    |       |
| A264        | SP   | 115     | 2    | 0.75    | Trane 7002-3443   | K    |       |
| A265        | SP   | 115     | 2    | 0.75    | Trane 7002-3444   | K    |       |
| A266        | SP   | 115     | 2    | 1       | Trane 7002-3445   | K    |       |
| A267        | SP   | 115     | 2    | 1.4     | Trane 7002-3446   | K    |       |
| A268        | SP   | 115     | 2    | 1.4     | Trane 7002-3447   | K    |       |
| A269        | SP   | 208-230 | 1    | .58-.60 | Trane 7021-11054  | L    |       |
| A270        | PSC  | 208-230 | 2    | .42-.50 | Trane 7062-5033   | M    |       |
| A271        | PSC  | 208-230 | 2    | 0.62    | Trane 7062-3969   | N    |       |

NOTES: 20: 4M 370V Capacitor included



FIG. A A130



FIG. B A150



FIG. C A190



FIG. D A191



FIG. E A192



FIG. F A193



FIG. G A194



FIG. H A195



FIG. I A196



FIG. J A197



FIG. K A198, A199, A260, A261, A262, A263, A264, A265, A266, A267, A268



FIG. L A269



FIG. M A270



FIG. N A271

Thermally protected • UL recognized • CSA or ULc certified  
**NOTE:** Rotation is determined by looking at shaft end. Shaft length is measured from motor face.

NEW ITEM! See page 113 for a complete listing of all our new products.



| FASCO MODEL | TYPE | VOLTS   | SPD. | AMPS | CROSS REF.  | FIG. | NOTES |
|-------------|------|---------|------|------|---|------|-------|
| A272        | PSC  | 208-230 | 2    | 0.65 | Trane 7062-3971   | A    |       |
| A273        | PSC  | 208-230 | 2    | 0.62 | Trane 7062-3972   | A    |       |
| A274        | PSC  | 208-230 | 1    | 0.28 | Trane 7062-3973   | A    |       |
| A276        | SP   | 115     | 1    | 1    | Trane 7021-9011   | B    |       |
| A278        | SP   | 115     | 2    | 1.4  | Trane 7002-2530   | C    |       |
| A279        | SP   | 115     | 2    | 0.75 | Trane 7002-2531   | C    |       |
| A360        | SP   | 115     | 2    | 1    | Trane 7002-2532   | C    |       |
| A361        | SP   | 115     | 1    | 1.6  | Trane 7002-2558   | D    |       |
| A362        | SP   | 115     | 1    | 1.6  | Trane 7002-3273   | C    |       |
| A367        | SP   | 115     | 2    | 0.95 | Trane 7021-8051   | E    |       |
| A368        | PSC  | 115     | 2    | 0.8  | Trane 7062-3782   | F    |       |
| A369        | PSC  | 208-230 | 2    | 0.34 | Trane 7062-3915   | G    |       |
| A370        | PSC  | 208-230 | 2    | 0.18 | Trane 7062-3918   | G    |       |
| A373        | SP   | 208-230 | 1    | 0.6  | Trane 7021-9396   | H    |       |
| A118        | SP   | 115     | 1    | 1.8  | Williamson 100,000 BTU Furnaces 7021-6999, 7021-7042        | I    | 135   |
| A080        | SP   | 115     | 1    | 1.1  | Williamson 7021-5510, 02-568; Franklin F3670-1; Rotron RFB6 | J    |       |
| A083        | SP   | 230     | 1    | 0.8  | York 026-16323-0000, 02620224-000, 7021-1373                | K    | 51    |
| A063        | SP   | 230     | 1    | 0.6  | York 026-22239-700, 7021-4314                               | L    |       |
| A144        | SP   | 208-230 | 1    | 0.5  | York 7021-6770  | M    | 51    |
| A137        | PSC  | 115     | 1    | 0.7  | York International 7062-2442, 7062-3484, 024-25057-000      | N    | 133   |
| A154        | SP   | 115     | 1    | 1.2  | York 7021-9428  | O    |       |

NOTES: 51: Includes centrifugal switch 133: 4M 250V Capacitor included 135: Leads require modification



FIG. A A272, A273, A274



FIG. B A276



FIG. C A278, A279, A360, A362



FIG. D A361



FIG. E A367



FIG. F A368



FIG. G A369, A370



FIG. H A373



FIG. I A118



FIG. J A080



FIG. K A083



FIG. L A063



FIG. M A144



FIG. N A137



FIG. O A154





| FASCO MODEL | TYPE | VOLTS   | SPD. | AMPS | CROSS REF.                           | FIG. | NOTES |
|-------------|------|---------|------|------|--------------------------------------|------|-------|
| A165        | PSC  | 115     | 1    | 0.7  | York 7062-3958                       | A    | 20    |
| A168        | PSC  | 115     | 1    | 0.7  | York, Excel, Ducane 7062-5019        | B    |       |
| A220        | SP   | 115     | 1    | 1.6  | York 7021-5838, 7021-7217, 7021-9054 | C    |       |
| A221        | SP   | 208-230 | 1    | 0.55 | York 7021-8318, 7021-6691            | D    |       |
| A222        | SP   | 115     | 1    | 1.05 | York 7021-8317, 7021-7481            | E    |       |
| A223        | SP   | 208-230 | 1    | 0.64 | York 7021-10096, 7021-9656           | F    |       |
| A224        | SP   | 115     | 2    | 0.8  | York 7062-5048, 7062-4743            | G    |       |
| A225        | SP   | 115     | 1    | 2.25 | York 7021-11577, 7021-11577S         | H    |       |
| A226        | SP   | 115     | 1    | 1.7  | York 7058-0266, 7058-0266S           | I    |       |
| A227        | SP   | 115     | 1    | 0.7  | York 7062-4708S, 7062-4708           | J    |       |
| A228        | SP   | 115     | 1    | 2    | York 7002-3285, 7002-2941            | K    |       |
| A229        | SP   | 115     | 1    | 1.75 | York 7058-0267S, 7058-0267           | L    |       |
| A230        | PSC  | 115     | 2    | 0.8  | York 7062-5094S, 7021-5094           | M    |       |
| A231        | SP   | 115     | 2    | 1.3  | York 7021-10213                      | N    |       |
| A234        | PSC  | 208-230 | 1    | 0.5  | York 7062-5155                       | O    |       |

NOTES: 20: 4M 370V Capacitor included



FIG. A A165



FIG. B A168



FIG. C A220



FIG. D A221



FIG. E A222



FIG. F A223



FIG. G A224



FIG. H A225



FIG. I A226



FIG. J A227



FIG. K A228



FIG. L A229



FIG. M A230



FIG. N A231



FIG. O A234

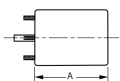

Thermally protected • UL recognized • CSA or ULc certified  
**NOTE:** Rotation is determined by looking at shaft end. Shaft length is measured from motor face.

▶ NEW ITEM! See page 113 for a complete listing of all our new products.